

LEGEND

- PROPOSED ADOPTABLE FOOTPATH
- PROPOSED VEHICLE ACCESS
- PROPOSED HB2 KERB
- PROPOSED 25mm UPSTAND KERB
- PROPOSED DROPPED FLUSH KERB
- PROPOSED PATH EDGING
- PROPOSED DROPPER KERB
- PROPOSED TACTILE PAVING
- EXISTING PUBLIC SURFACE WATER SEWER
- EXISTING PUBLIC SURFACE WATER MANHOLES
- PROPOSED S38 HIGHWAY DRAIN
- PROPOSED SHW HIGHWAY SOAKAWAY
- PROPOSED SHW HIGHWAY DRAIN
- PROPOSED SHW HIGHWAY GULLY
- SHW EXTENT OF HIGHWAY WORKS BOUNDARY

INSPECTIONS REQUIRED BY THE HIGHWAYS INSPECTOR

THE CONTRACTOR SHALL GIVE ADVANCE NOTICE TO NORFOLK COUNTY COUNCIL TO ALLOW THE INSPECTOR PROPER INSPECTION AND CHECKING OF THE WORKS AT THE FOLLOWING DESIGNATED STAGES:

1. PRIOR TO START OF WORKS A PHOTOGRAPHIC RECORD OF EXISTING HIGHWAY CONDITION ADJACENT TO DEVELOPMENT TO BE AGREED & RECORDED
2. START OF THE WORKS
3. BEFORE BACK-FILLING ANY TRENCHES UNDER THE NEW HIGHWAY
4. COMPLETION OF FORMATION
5. COMPLETION OF SUB-BASE
6. ARRIVAL & PLANTING OF TREES
7. LAYING OF BASE
8. LAYING OF BINDER COURSE
9. LAYING OF SURFACE COURSE
10. ALL DAMAGE TO EXISTING HIGHWAY RESULTING FROM CONSTRUCTION TRAFFIC TO BE REPAIRED BEFORE THE INSPECTOR WILL RECOMMEND WORKS FOR INTERIM ADOPTION

NO STREET LIGHTING SHALL BE INSTALLED UNTIL ITS FINAL POSITION HAS BEEN AGREED WITH THE STREET LIGHTING ENGINEER.

GENERAL NOTES:

1. THE DRAWINGS, DESIGN AND ALL INFORMATION CONTAINED THEREIN ARE THE SOLE COPYRIGHT OF CANHAM CONSULTING LTD AND ANY REPRODUCTION IS FORBIDDEN UNLESS PERMISSION IS OBTAINED IN WRITING.
2. ALL DRAWINGS SHALL BE READ IN CONJUNCTION WITH ALL RELEVANT CIVIL / STRUCTURAL ENGINEERING DRAWINGS, THE PROJECT SPECIFICATION AND DRAWINGS PRODUCED BY THE ARCHITECTS, SERVICE ENGINEERS AND LANDSCAPE ARCHITECTS.
3. THE PROPOSED SITE LAYOUT IS BASED UPON THE WT DESIGN LTD DRAWING 080-19-0450-C8, DATED 15th MARCH 2021.
6. ANY DISCREPANCIES BETWEEN THE INFORMATION GIVEN BY THE ENGINEER, AND THAT PROVIDED BY OTHERS, MUST BE REFERRED TO THE ENGINEER BEFORE THE AFFECTED WORKS PROCEED.
7. DIMENSIONS MUST NOT BE SCALED FROM THE ENGINEER'S DRAWINGS.
8. ALL DIMENSIONS ARE IN METRES UNLESS NOTED OTHERWISE.
9. DIMENSIONS MARKED * ARE SUBJECT TO CONFIRMATION BY SITE MEASUREMENT BEFORE CONSTRUCTION PROCEEDS.
10. THE CONTRACTOR IS TO ENSURE THE STABILITY OF EACH ELEMENT AND THE STABILITY OF THE OVERALL CONSTRUCTION UNTIL THE WORKS ARE COMPLETE.
11. ALL DESIGNS, CONNECTIONS, WORKMANSHIP AND MATERIAL ARE TO COMPLY WITH THE CURRENT BUILDING REGULATIONS AND THE LATEST RELEVANT BRITISH STANDARD SPECIFICATION AND CODES OF PRACTICE OR OTHERWISE BE TO THE SPECIFIC WRITTEN APPROVAL OF THE ENGINEER.
12. INSPECTIONS MADE BY THE LOCAL AUTHORITY, SHALL BE ARRANGED BY THE CONTRACTOR TO SUIT HIS PROGRAMME. ANY COST ARISING OUT OF FAILING TO CARRY OUT THE WORK TO THE SATISFACTION OF THE LOCAL AUTHORITY WILL BE THE SOLE RESPONSIBILITY OF THE CONTRACTOR.
13. THE CONTRACTOR MUST MAKE HIMSELF AWARE OF THE EXISTING UTILITIES / SERVICES LOCATED WITHIN AND ADJACENT TO THE SITE. **NO EXCAVATIONS ARE TO BE UNDERTAKEN UNTIL THE UTILITY COMPANIES HAVE BEEN INFORMED / CO-ORDINATED WITH.** DIAL-BEFORE-YOU-DIG ADVICE IS FOLLOWED AND THE AREA IS CAT SCANNED. ALL UTILITY COMPANY GUIDELINES AND HEALTH & SAFETY PROCEDURES MUST BE STRICTLY FOLLOWED.
14. FOR SIZE AND LOCATION OF ALL SERVICES REFER TO THE SERVICE ENGINEER'S AND ARCHITECTS DRAWINGS.

ADOPTABLE HIGHWAYS NOTES:

1. ALL PROPOSALS FOR ADOPTABLE HIGHWAYS MUST ATTAIN TECHNICAL APPROVAL FROM NORFOLK COUNTY COUNCIL PRIOR TO CONSTRUCTION. **ALL WORKS CARRIED OUT PRIOR TO TECHNICAL APPROVAL ARE UNDERTAKEN AT THE CONTRACTOR'S RISK.**
2. ADOPTABLE AREAS ARE TO BE CONSTRUCTED IN LINE WITH NORFOLK COUNTY COUNCIL SPECIFICATION.
3. THE CONTRACTOR IS TO ARRANGE INSPECTIONS WITH NORFOLK COUNTY COUNCIL ENGINEER.
4. ALL MATERIALS AND WORKMANSHIP TO COMPLY WITH THE DEPARTMENT FOR TRANSPORT SPECIFICATION FOR HIGHWAY WORKS, FORMING VOLUME 1 OF THE MANUAL OF CONTRACT DOCUMENTS FOR HIGHWAY WORKS (MCHW) PUBLISHED BY THE HIGHWAYS AGENCY.
5. ALL LINING TO BE THERMOPLASTIC SCREED WITH APPLIED SOLID GLASS BEADS TO CHAPTER 5 OF THE TRAFFIC SIGNS MANUAL.
6. THE TRENCH REINSTATEMENT OF THE INSTALLATION OF THE NEW DRAINAGE PIPES MUST BE CONSTRUCTED IN ACCORDANCE WITH THE HIGHWAYS AUTHORITIES & UTILITIES COMMITTEE (HAUC) CODE OF PRACTICE FOR ROAD CATEGORY TYPE 3 CONSTRUCTION.
7. BOND COAT TO BS594987 APPLIED TO ALL BOUND LAYERS.
8. ALL LONGITUDINAL JOINT LOCATIONS TO COMPLY WITH MCHW CLAUSE 903/21
9. THE TOPOGRAPHICAL INFORMATION REPRODUCED ON THIS DRAWING IS SHOWN FOR CO-ORDINATION AND DESIGN PURPOSES ONLY AND TAKEN FROM THE NPS PROPERTY CONSULTANTS LTD DRAWING VES 1310, DATED 27TH JUNE 2013. LIABILITY FOR THIS INFORMATION REMAINS WITH NPS PROPERTY CONSULTANTS LTD. CANHAM CONSULTING LTD CANNOT ACCEPT ANY LIABILITY FOR THE CONTENT AND ACCURACY OF THE TOPOGRAPHIC SURVEY.



OVERVIEW PLAN

SCALE 1:2500

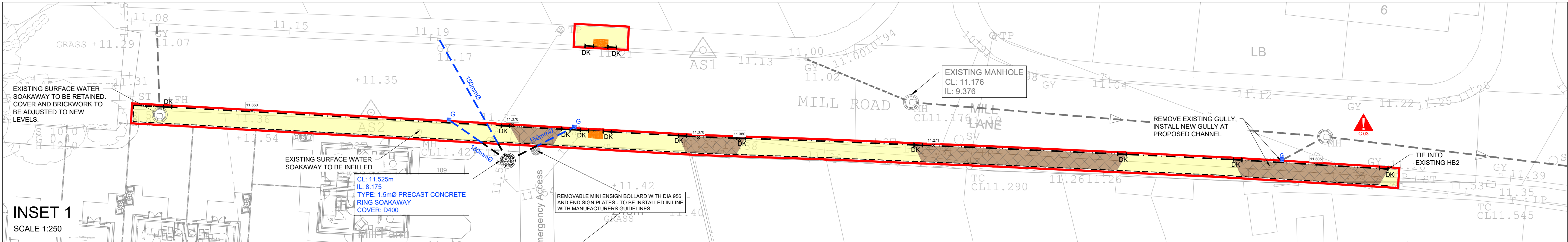

INSET 1

SCALE 1:250

PRELIMINARY DRAWING:
THIS DRAWING IS FOR PRELIMINARY PURPOSES ONLY AND MUST NOT BE READ AS A CONSTRUCTION ISSUE.
IT INDICATES DESIGN INTENT ONLY AND IS SUBJECT TO AMENDMENT DURING FINAL DESIGN DEVELOPMENT.

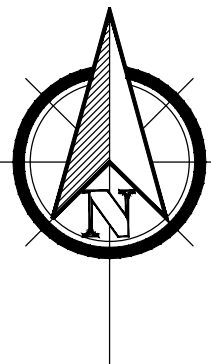

RESIDUAL RISKS:

- C 01
- CONTACT WITH LIVE SERVICES (SITE-WIDE RISK).
LOCATION OF ALL EXISTING BURIED SERVICES TO BE VERIFIED & VISUALLY MARKED ON SITE - APPROPRIATE HEALTH & SAFETY PROTECTIVE MEASURES AND WORK PRACTICES TO BE INSTATED
- C 02
- DAMAGE TO EXISTING SERVICE INFRASTRUCTURE (SITE-WIDE RISK).
LOCATION OF ALL EXISTING BURIED SERVICES TO BE VERIFIED & VISUALLY MARKED ON SITE - APPROPRIATE HEALTH & SAFETY PROTECTIVE MEASURES AND WORK PRACTICES TO BE INSTATED
- C 03
- CONTACT WITH LIVE TRAFFIC & PEDESTRIANS - APPROPRIATE TRAFFIC MANAGEMENT & PEDESTRIAN MANAGEMENT TO BE INSTATED

P01	13.04.21	PRELIMINARY ISSUE		GPC	IG
rev	date	details		drawn	checked



Structural Engineers **Civil Engineers** **Building Surveyors**

+44 (0)1603 430650 | mail@canhamconsulting.co.uk | www.canhamconsulting.co.uk

client

LOVELL

architect

WT DESIGN LTD

project

LAND NORTH OF NORWICH ROAD,
ACLE

title

SMALL HIGHWAY WORKS:
GENERAL ARRANGEMENT

CCL ref: 213114 JCR design IG checked IG scale AS SHOWN size A1 (L) date 13.04.2021

status:

S3 - SUITABLE FOR REVIEW & COMMENT

drawing number

213114-CCL-XX-00-DR-C-5310 P01

revision

© This drawing is copyright and is not to be reproduced without the written permission of Canham Consulting Ltd